

Daewoo Mini Washer – Troubleshooting Guide

NCE RECOMMENDS SOME SIMPLE TROUBLESHOOTING STEPS FOR THE IE OR OE ERROR CODES TO ASSIST WITH A REMEDY FOR A FAILURE

ERROR CODES

[IE \(Input Error\) Error - Failure in Water Supply](#)

- 1 The preset water level is not reached within 20 minutes after the water supply starts or resumes.
 - 2 During wash: The error occurs 4 minutes after the water level remains unchanged or 20 minutes after the water level starts changing.
 - 3 During rinse: The error occurs 20 minutes after the cycle starts.
- 2) The "LE" error flickers on the display panel.
 - 3) If the Power button is turned off and on, the error display disappears.

ENSURE THE MACHINE IS TURNED ON. CHECK WATER FLOW INTO THE MACHINE. ENSURE WATER FAUCETS AND TAPS ARE TUNED ON AT THE SOURCE AND ASLO WITHIN THE RV. ENSURE THAT THE WATER PRESSURE IS SUFFICIENT TO FILL THE DRUM. WATERFLOW WILL BE EFFECTED, IF USING A 12v PUMP, BY THE DISTANCE TO THE UNIT FROM THE WATER SOURCE, THE HEIGHT OF THE UNIT FROM THE WATER SOURCE AND QUALITY OF THE WATER (IMPEDIMENTS ETC).

ENSURE THE WATER INLET HOSE ARE NOT TWISTED OR KINKED RESTRICTING WATER FLOW

[OE \(Output Error\) Error - Failure in Water Drainage](#)

- 1 The preset water level is not reached within 10 minutes after the water starts being drained.
 - 2 Overload situations caused by failures in drainage take place 18 times during the final main spin cycle.
- 2) The "LE" error flickers on the display panel.
 - 3) If the Power button is turned off and on, the error display disappears.

CHECK WATER FLOW FROM THE MACHINE IS NOT RESTRICTED. CHECK THE DRAIN HOSE IS NOT TWISTED OR KINKED. DRAIN HOSE REQUIRES A MINIMUM OF 100MM STRAIGHT FALL PRIOR TO ANY CHANGES IN ANGLE.

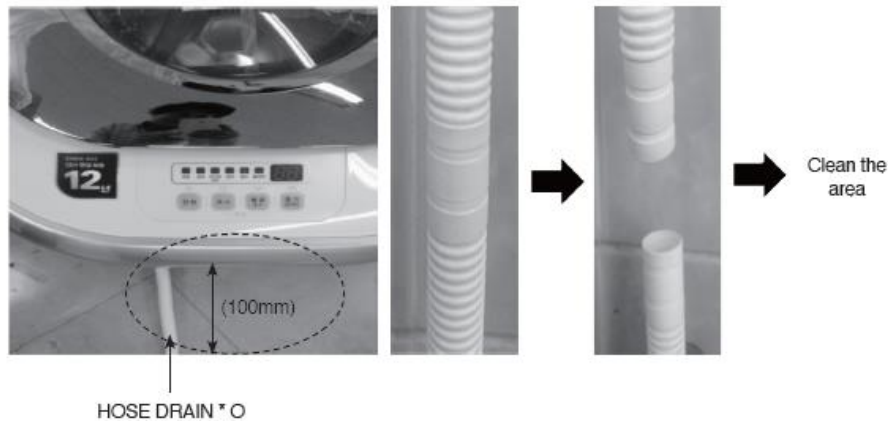

CHECK THE DRAIN FILTER AND DRAIN MOTOR ARE CLEAR OF IMPEDIMENTS. WHEN REMOVING CAP, FIRST REMOVE THE SCREW WITHIN THE CAP ITSELF THEN TWIST TO REMOVE

- * Inspect whether the drainage valve is clogged with dust and impurities
- * Inspect whether any impurities exist between the bellows and housing to cause minor drainage (leaks)

- * Detach the cap filter drain to the clockwise after detach the base screw
- * Clean the cap filter drain removing any impurities
- * After cleaning, turn the cap filter drain counterclockwise tightly

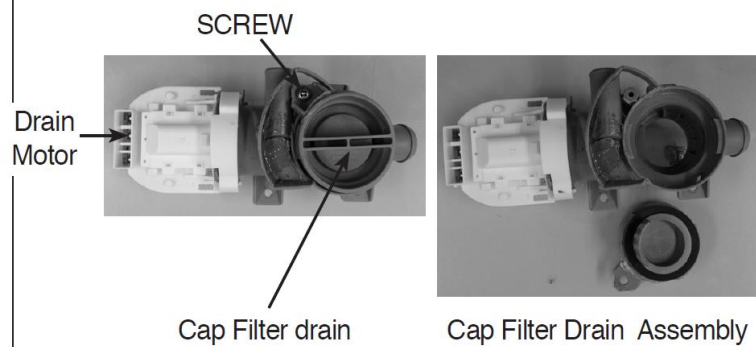

CHECK THE CONNECTION FOR THE DRAIN HOSE. IF THE DRAIN HOSE IS CONNECTED INTO THE BASIN OR SINK DRAIN OUTLET, ENSURE THE PLUG IN THE BASIN OR SINK IS OPEN TO AVOID A VACUUM OCCURRING TO CREATE AN AIRLOCK EFFECT.

CHECK ANY SULLAGE HOSE THAT IS ATTACHED TO THE DRAIN FUNCTION OF THE DRAIN HOSE. ENSURE THERE ARE NO KINKS OR BLOCKAGES.

If the above quick troubleshooting steps do not remedy the error, please call your selling dealer or NCE for assistance