

Youtube update for 7.1 Android operating system

Update method:

Step 1: Please download the update via following link

<https://tinyurl.com/u7s94mq>

Step 2: Copy all files to a USB (ensure no other files are present on the USB chosen). Make sure the following files are saved as follows:

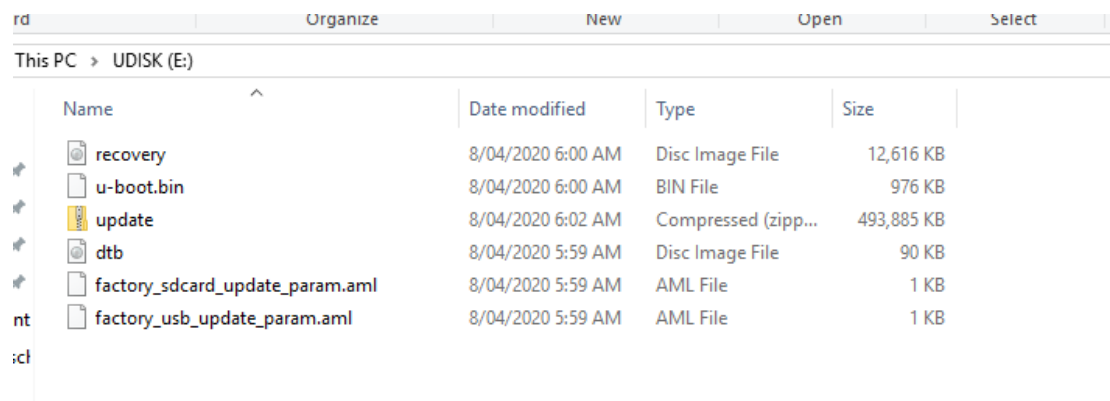

Name	Date modified	Type	Size
recovery	8/04/2020 6:00 AM	Disc Image File	12,616 KB
u-boot.bin	8/04/2020 6:00 AM	BIN File	976 KB
update	8/04/2020 6:02 AM	Compressed (zipp...	493,885 KB
dtb	8/04/2020 5:59 AM	Disc Image File	90 KB
factory_sdcard_update_param.aml	8/04/2020 5:59 AM	AML File	1 KB
factory_usb_update_param.aml	8/04/2020 5:59 AM	AML File	1 KB

Step 3: Plug in the USB to the TV using the network port (DO NOT PLUG INTO STANDARD USB POINT), enter Settings in smart TV menu and click "System update". It may take 30seconds to recognize the file:

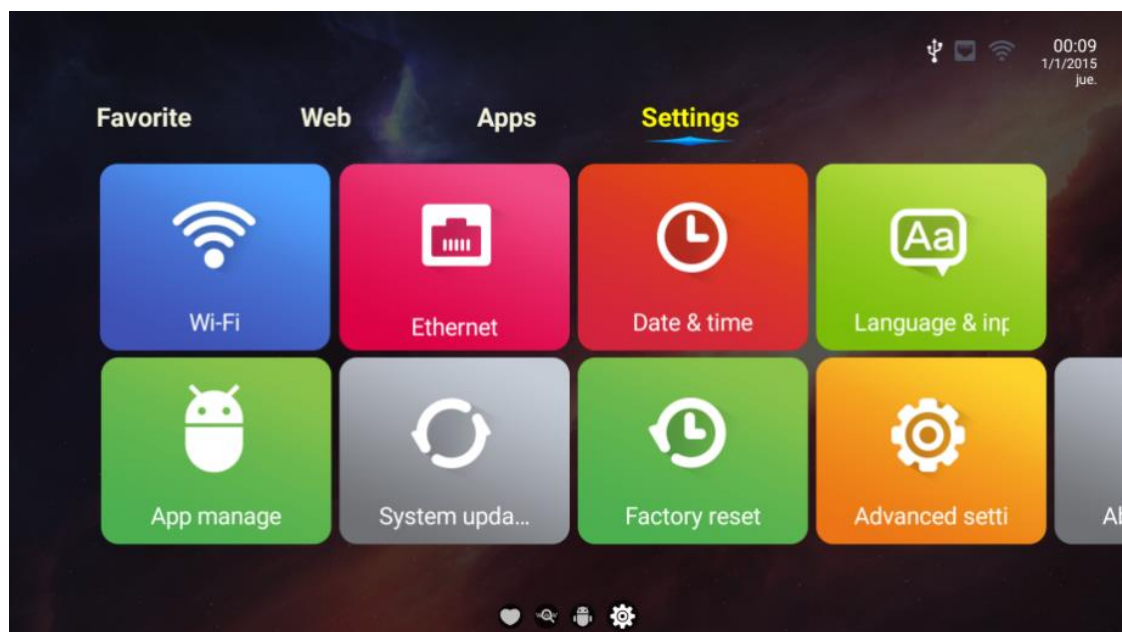

Step 4: Click “Local update”

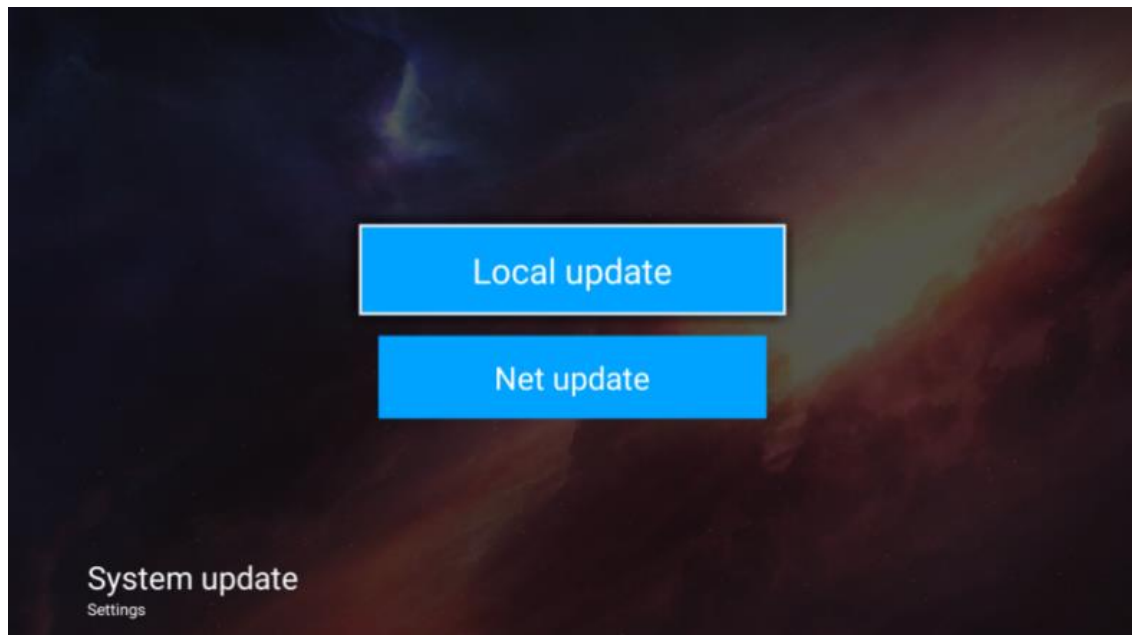

Step 5: Select the update.zip in the USB

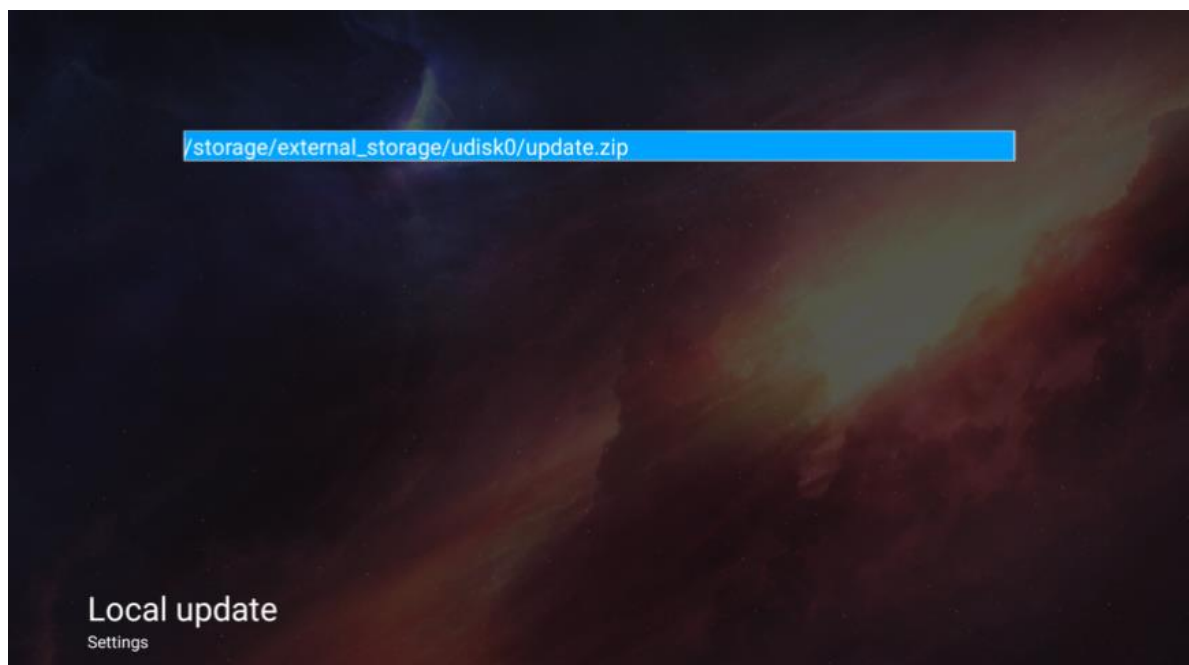

Step 6: Wait for to system to reboot.

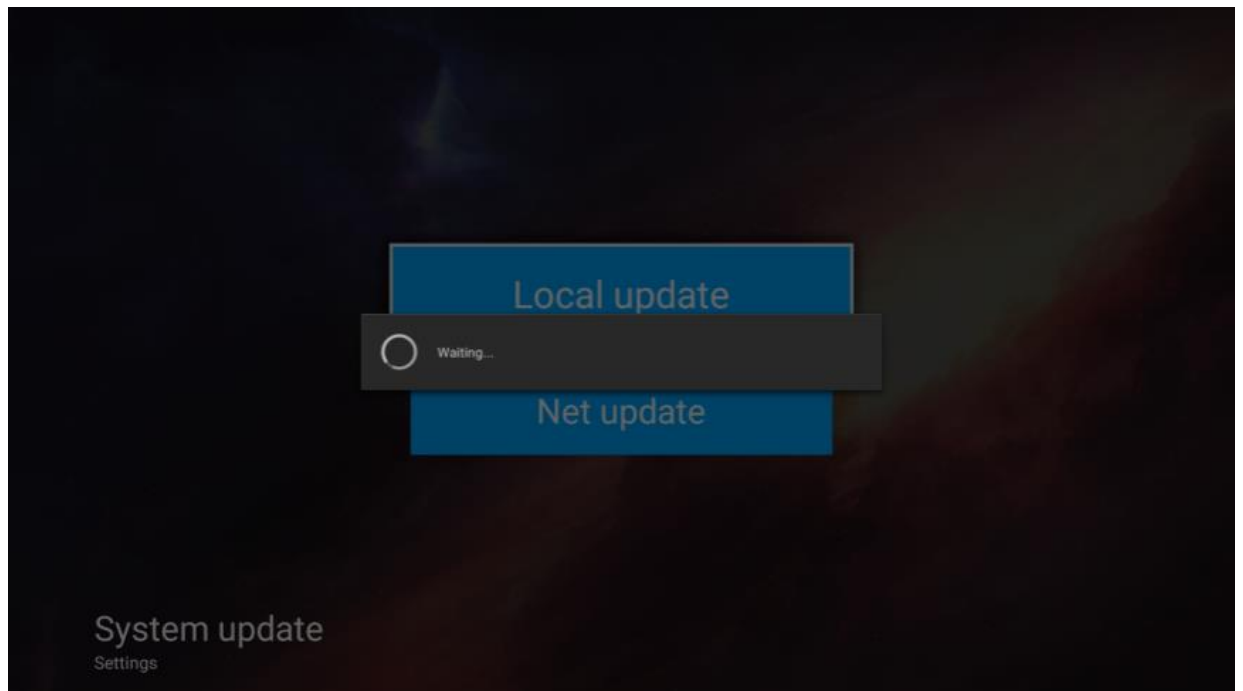

Step 7: The upgrade interface will appear as below (note: don't unplug the power)

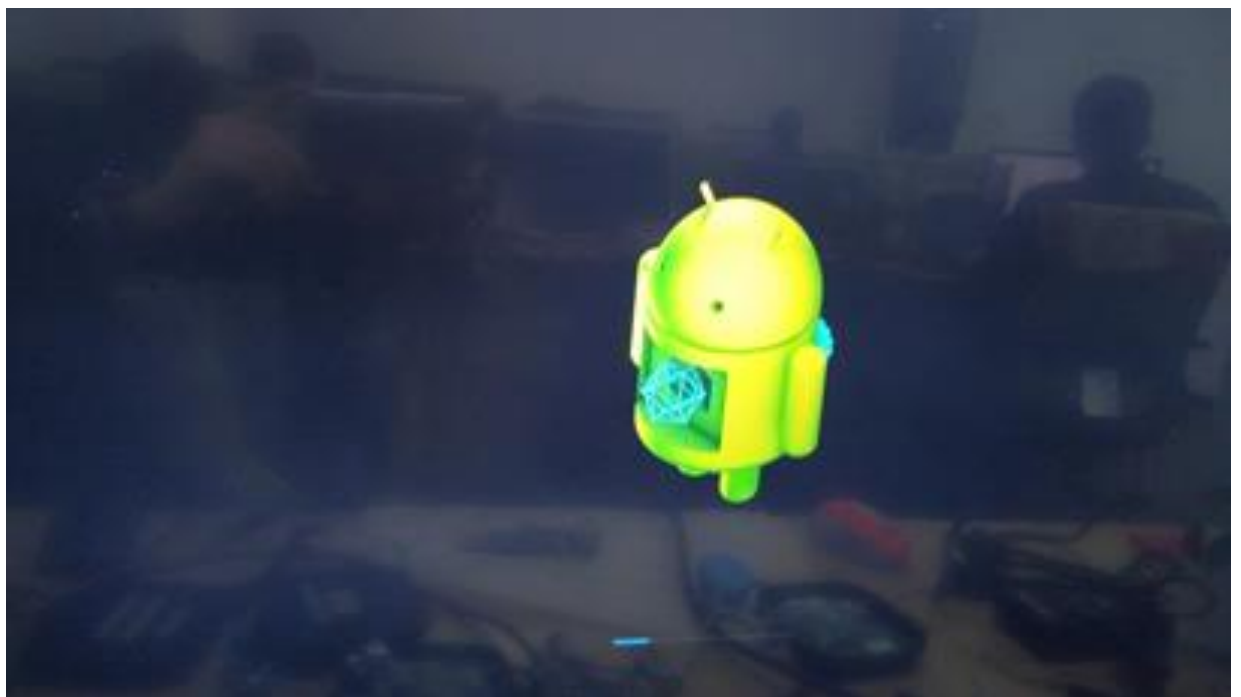

Step 8: When finished the upgrade, the machine will reboot. Once rebooted, again enter Settings to select “Factory reset”.

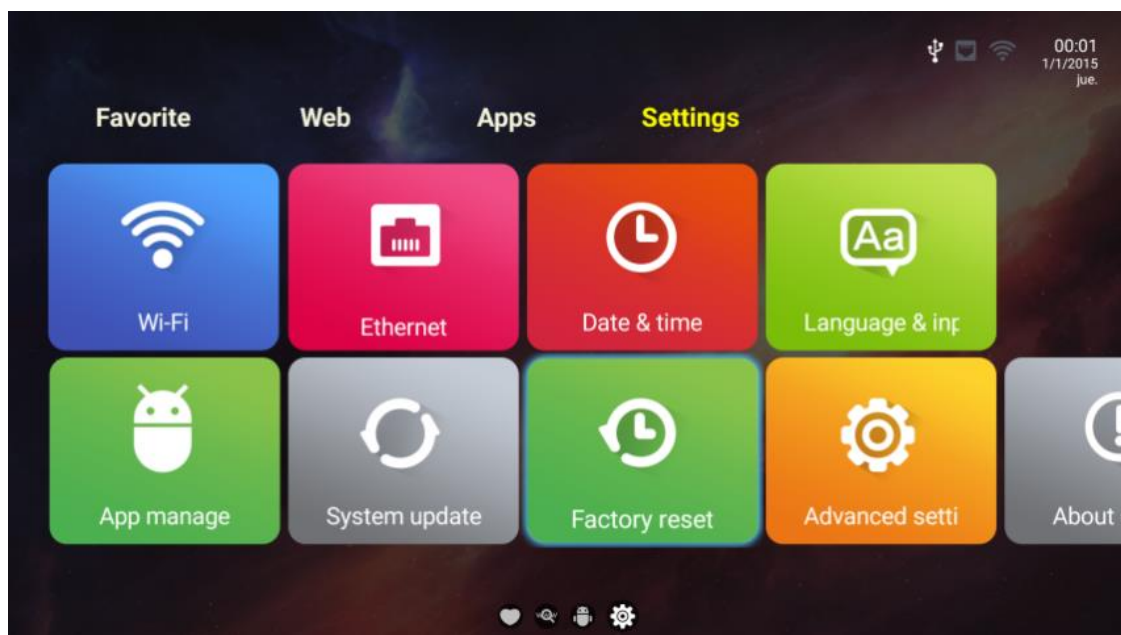

Step 9: Click “Yes” to reset the system. This will load the program.

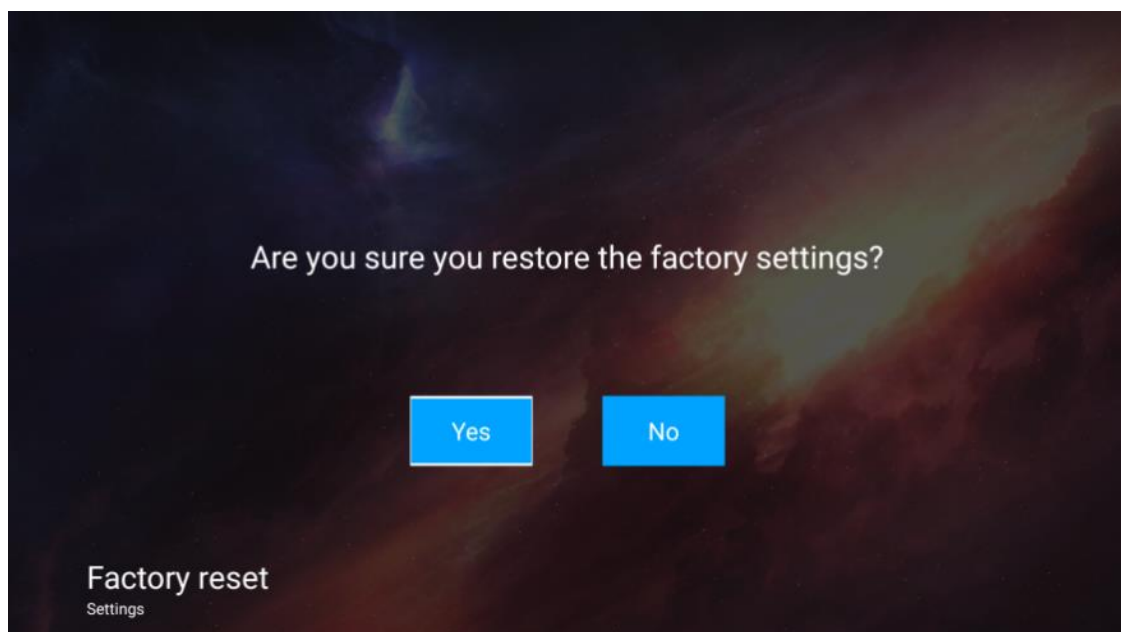

Step 10: Once reset has been completed, start the setup process again by entering your Wi-Fi log-in details.

The process is now complete and You Tube will work as normal.